



10 Willant Close
 Maidenhead
 £525,000 Freehold

10 Willant Close
Maidenhead, Berkshire SL6 3NL

Price £525,000 Freehold

‘A good sized semi detached bungalow in a popular cul-de-sac location’

A 2/3 bedroom semi-detached bungalow situated towards the end of a cul-de-sac which would now benefit from some modernisation located within a stones throw of local shops and amenities at Woodlands Park. Maidenhead town centre and station are about two and a half miles away. The property, which is being sold with no onward chain, benefits from a lovely garden, double length garage and driveway.

Council Tax band: E EPC rating: C

The M4 and M40 motorway are easily accessible providing access to Heathrow and Central London. Rail services to London Paddington are available from Maidenhead Station with an excellent service to London Paddington and directly into the city centre via the Elizabeth Line.

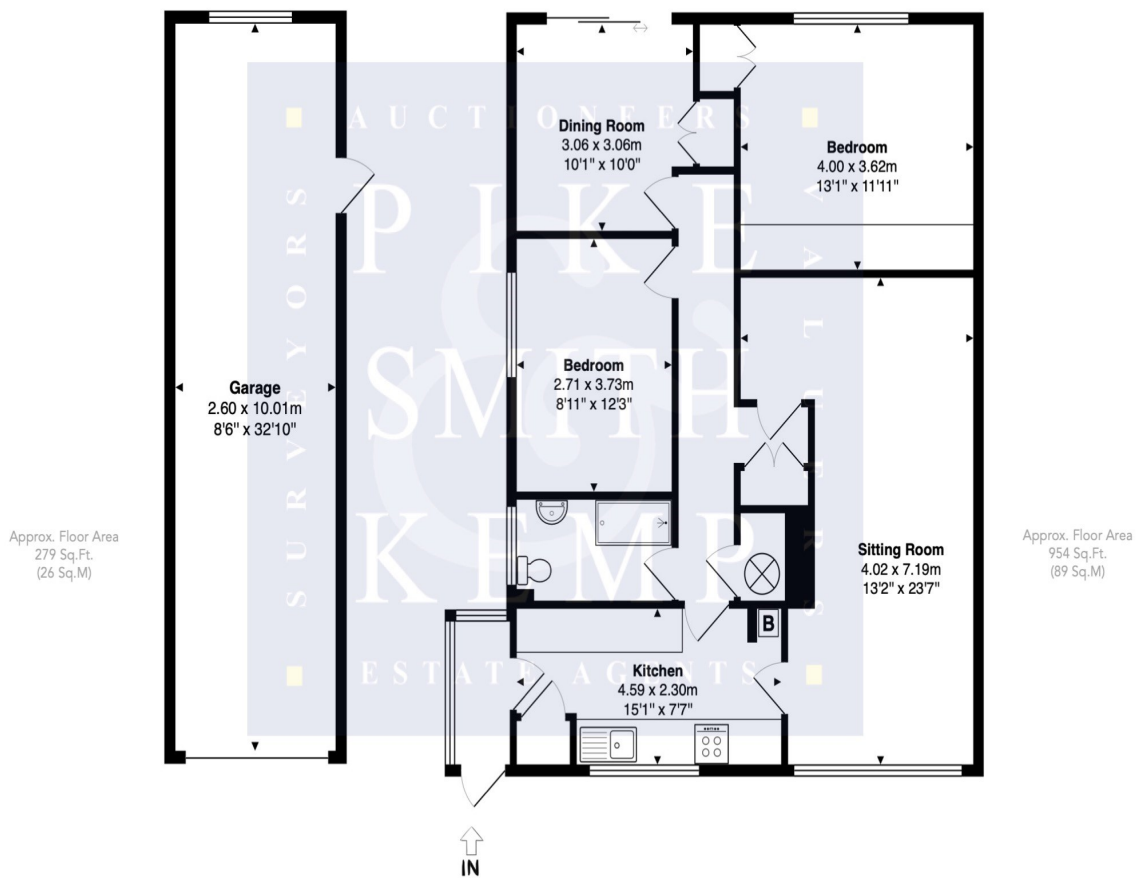

The approximate total area for the elements of the property represented on the floorplan is 115 SqM (1233 Sq.Ft)

10 Willant Close, Maidenhead, Berkshire, SL6 3NL

This floor plan provided by Expert Survey Solutions Ltd is for indicative guidance only. Whilst every attempt has been made to ensure the accuracy of the floor plans contained here, measurements of doors, windows and rooms are approximate and no responsibility is taken for any error, omission or mis-statement. Details shown on this floorplan including all measurements, areas and proportions cannot be guaranteed by either the provider or marketing estate/letting agency and should not be relied upon. If there is any area where accuracy is required, please contact the appropriate agent for clarification.





PIKE SMITH & KEMP

22 QUEEN STREET, MAIDENHEAD, BERKSHIRE SL6 1HZ

MAIDENHEAD@PIKESMITHKEMP.CO.UK

www.pskweb.co.uk

01628 621177