



3 Sherringham Court
Maidenhead

Price £110,000 Leasehold

3 Sherringham Court, East Road
Maidenhead, Berkshire, SL6 1PQ

Price £110,000 Leasehold

“A ground floor apartment in an attractive period building with good communal facilities”

A light and airy ground floor retirement apartment (males over 65 and females over 60) in the Victorian portion of this established development which is located in a pleasant tree lined road within a short walk of the High Street and railway station. Sherringham Court is a warden assisted property with well appointed residents lounge providing comfortable and secure living with pleasant outside space and off street parking.

Road links are accessible via junction 8/9 of the M4 motorway providing access to the M25, Central London, Heathrow Airport and the West Country.

ENTRANCE HALL: LIVING/DINING ROOM: KITCHEN: BEDROOM: BATHROOM

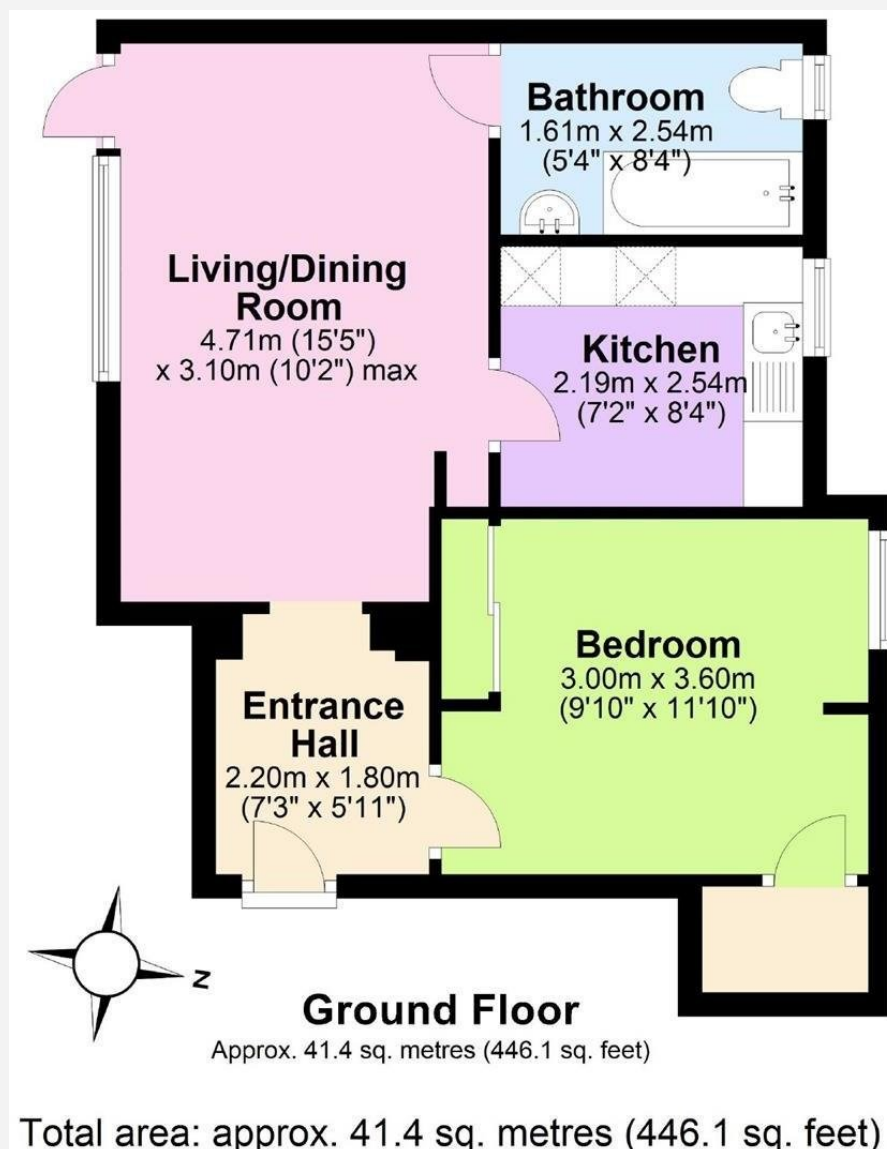





Directions: From Maidenhead town centre take the A4 towards Reading proceeding up Castle Hill, at the brow of the hill turn left into Grenfell Road, follow the road back down towards the town, cross the bridge and turn left into High Town Road at the bollards then take the second turning left into East Road.



PIKE SMITH & KEMP

22 QUEEN STREET, MAIDENHEAD, BERKSHIRE SL6 1HZ

MAIDENHEAD@PIKESMITHKEMP.CO.UK

01628 621177