



**1 Havelock Road
Maidenhead**

**1 Havelock Road
Maidenhead, Berkshire, SL6 5BJ**

“An extended bungalow offering well presented contemporary living accommodation”

A large detached bungalow having been the subject of a transformative extension and meticulous refurbishment. Using quality fittings the property benefits from attractive bath and shower rooms and a modern kitchen coupled with stylish décor. There are four good size bedrooms and an 'L' shape sitting/dining room. There is a large loft area suitable for conversion to further accommodation (STPP). The property sits on a generous plot with ample parking and is located in a popular residential road. A short walk to Newlands Girls School and within catchment for Buckinghamshire and Berkshire Grammar Schools.

The M4 and M40 motorway are easily accessible providing access to Heathrow and Central London. Rail services to London Paddington are available from Maidenhead Station with an excellent service to London Paddington and directly into the city centre via the Elizabeth Line.

EPC Rating: C Council Tax Band: F

PRICE: £925,000 FREEHOLD



Pike Smith & Kemp
22 Queen Street, Maidenhead
Berkshire SL7 1HZ

 **rightmove**.co.uk
The UK's number one property website

maidenhead@pikesmithkemp.co.uk
01628 621177

Zoopla.co.uk

Accommodation summary

- ENTRANCE HALL-
- SITTING ROOM-
- SNUG-
- KITCHEN/DINING ROOM-
- STUDY AREA-
- PRINCIPAL BEDROOM WITH EN-SUITE BATHROOM-
- THREE FURTHER BEDROOMS-
- WET ROOM-

Outside

- FRONT, SIDE AND REAR GARDEN MAINLY LAID TO LAWN-
- PATIO AREA-
- OFF STREET PARKING-





Havelock Road, Maidenhead, SL6 5BJ

Approx. Total Area: 161.0 m² ... 1733 ft²

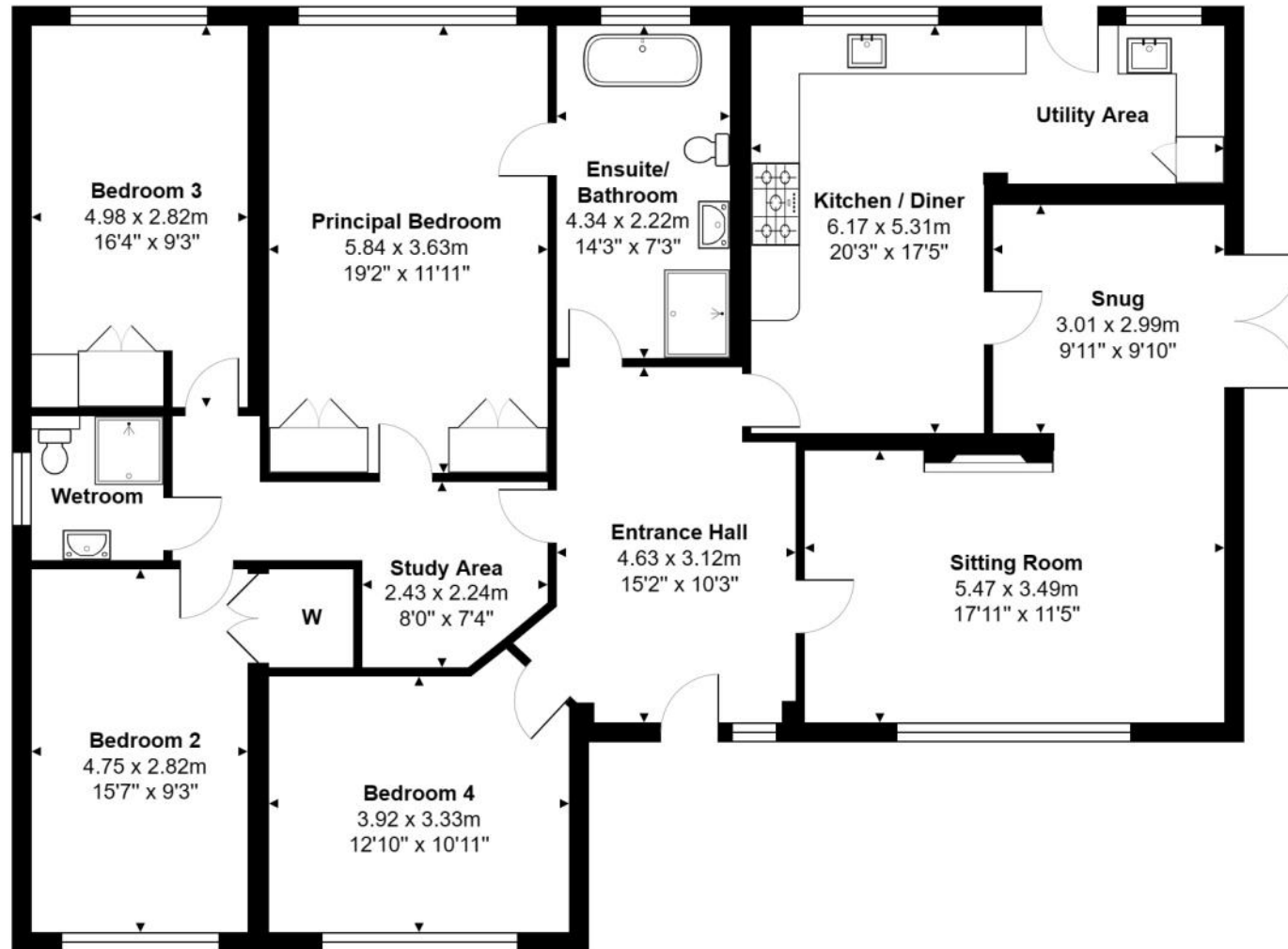

Whilst every attempt has been made to ensure the accuracy of the floorplans contained here, measurements of doors, windows and rooms are approximate and no responsibility is taken for any error, omission or mis-statement. These plans are for representation purposes only.







Directions: From Maidenhead town centre proceed west on the A4 towards Reading, at the top of Castle Hill bear right at the mini roundabout into St Marks Road. Continue along St Marks Road proceeding straight across the crossroads with All Saints Avenue and Courthouse Road where after take the next turning on the left into Havelock Road