



**192 Burghley Court  
Maidenhead  
Guide Price £205,000 Leasehold**

192 Burghley Court, Maidenhead  
Berkshire SL6 1AW

Guide Price £205,000 Leasehold

*“Immaculate 2nd floor apartment offered onto the market with no onward chain”*

A Superior one bedroom apartment situated on the popular Miller Homes development within walking distance of the town centre and station. The apartment offers modern open plan accommodation with the added benefit of a communal roof terrace, garden and allocated off street parking.

ZERO STAMP DUTY FOR FIRST TIME BUYERS.

**NO ONWARD CHAIN**

**ENTRANCE HALL: OPEN PLAN LIVING ROOM/KITCHEN: BEDROOM: BATHROOM:  
COMMUNAL ROOF TERRACE & GARDENS: ALLOCATED PARKING**

**Lease length:** 114 years

**Maintenance charge:** £800 per annum

**Ground rent:** £240 per annum

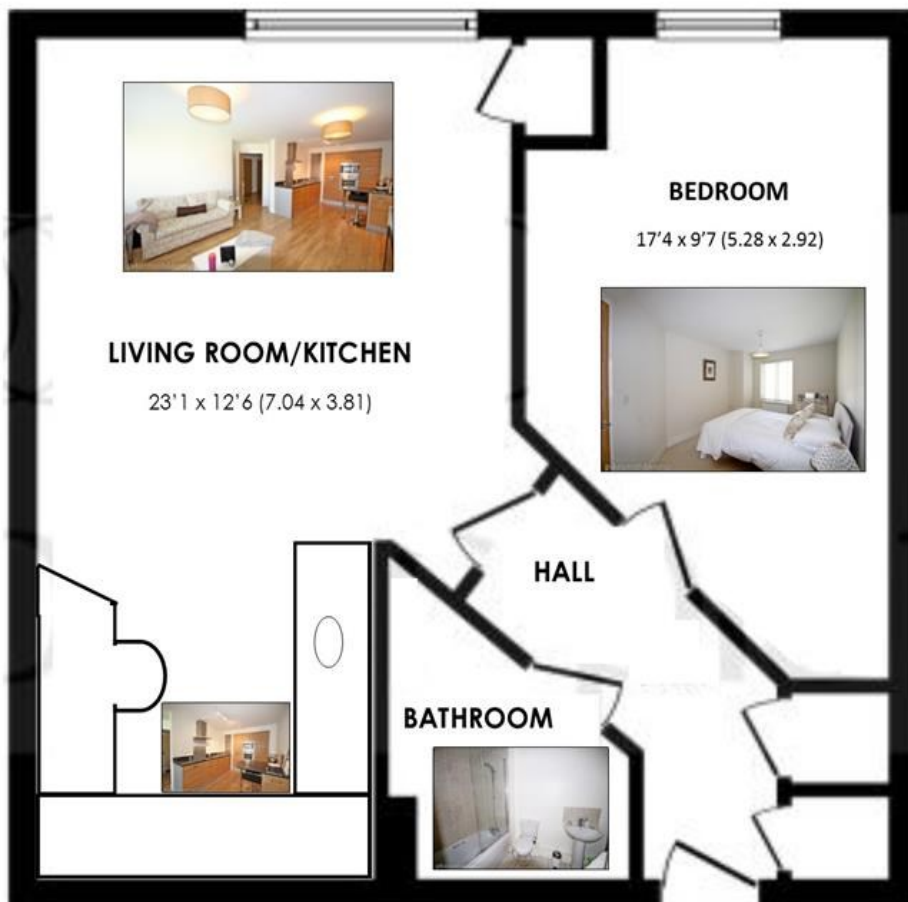

**Floor Plan**



■ AUCTIONEERS ■  
P I K E  
S M I T H  
K E M P  
■ SURVEYORS ■  
ESTATE AGENTS ■





**Directions:** From Maidenhead town centre take the A4 Bath Road east towards the river and Burgley Court will be found on the right hand side on the corner and at the junction with Oldfield Road.



PIKE SMITH & KEMP  
22 QUEEN STREET, MAIDENHEAD, BERKSHIRE SL6 1HZ  
MAIDENHEAD@PIKESMITHKEMP.CO.UK

01628 621177