



**CAMDEN ROAD
MAIDENHEAD**



Nova, Camden Road, Maidenhead Berkshire SL6 6HA

A significantly extended and much improved 4 bedroom family house located in a popular established road in the Furze Platt area within 1 mile of the town and station and within walking distance of both Furze Platt infants and secondary schools. The property benefits from off street parking to the front and a manageable garden and garage to the rear.

From Maidenhead town centre proceed north along the Marlow Road (A308) for just under 1 mile and turn left just after the Esso garage into Linden Avenue then first right into Camden Road.

EPC Rating: D
Council Tax Band: E

£650,000 FREEHOLD



Pike Smith & Kemp
22 Queen Street, Maidenhead
Berkshire SL7 1HZ

maidenhead@pikesmithkemp.co.uk
01628 621177

 **rightmove**.co.uk
The UK's number one property website

Zoopla.co.uk

Accommodation summary

Ground floor

-LIVING ROOM-
-KITCHEN / DINING ROOM-
-STUDY-
-CLOAKROOM-

First floor

-FOUR BEDROOMS-
-FAMILY BATHROOM-

Second floor

-DRESSING ROOM-
-EN SUITE-

Outside

-GARDEN-
-GARAGE IN THE REAR-





Camden Road, Maidenhead, SL6 6HA

Approx. Total Area: 151.0 m² ... 1626 ft²

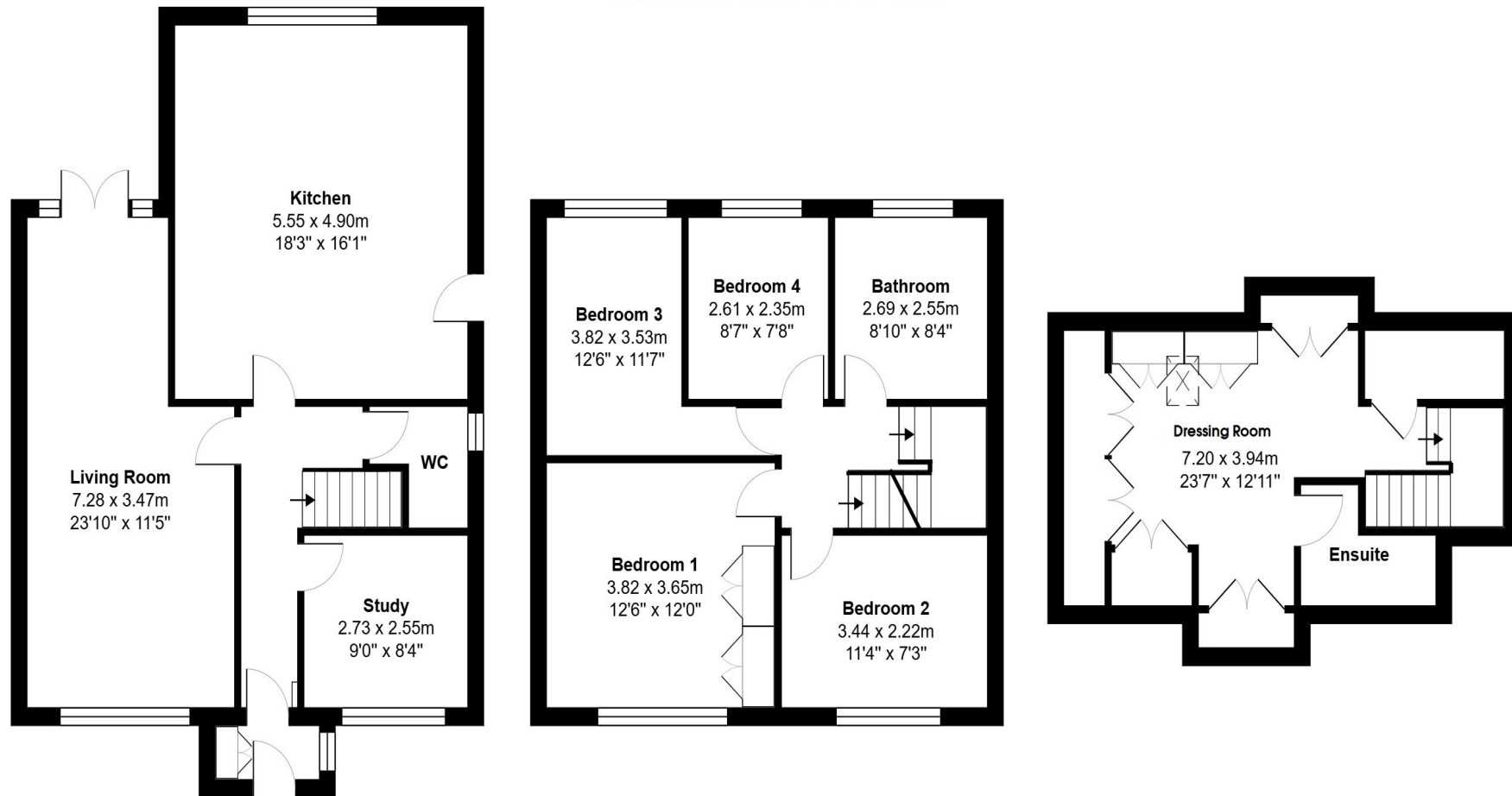

Whilst every attempt has been made to ensure the accuracy of the floorplans contained here, measurements of doors, windows and rooms are approximate and no responsibility is taken for any error, omission or mis-statement. These plans are for representation purposes only.







■ AUCTIONEERS ■
SURVEYORS ■ PIKE SMITH & KEMP ■ VALUERS ■
■ ESTATE AGENTS ■